

## Stainless Steel Equalizing Washers

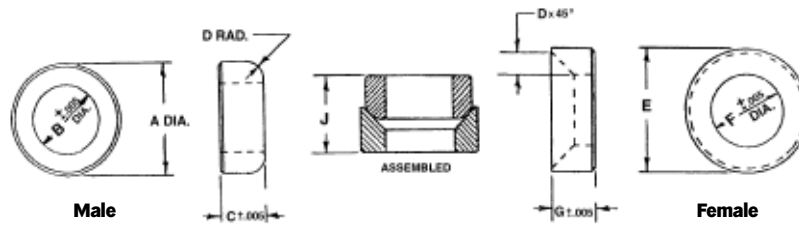

STAINLESS STEEL											
Bolt Size	Male					Female					Comb. Thick J
	PART #	A	B	C	D	PART #	E	F	G	D	
3/32	7281	9/32	.116	1/8	1/32	7291	3/8	5/32	1/8	5/64	13/64
1/8	7282	9/32	.144	1/8	1/32	7292	3/8	11/64	1/8	5/64	13/64
5/32	7283	5/16	.169	1/8	1/32	7293	3/8	3/16	1/8	1/16	13/64
3/16	7284	3/8	.196	5/32	5/64	7294	7/16	7/32	1/8	3/32	15/64
1/4	7285	7/16	.257	3/16	7/64	7295	1/2	9/32	5/32	3/32	17/64
5/16	7286	1/2	.323	3/16	1/16	7296	9/16	11/32	3/16	3/32	21/64
3/8	7287	5/8	.386	1/4	3/32	7297	11/16	13/32	1/4	1/8	27/64

CARBON STEEL											
Bolt Size	Male					Female					Comb. Thick J
	PART #	A	B	C	D	PART #	A	B	C	D	
3/32	5281	9/32	.116	1/8	1/32	5291	3/8	5/32	1/8	5/64	13/64
1/8	5282	9/32	.144	1/8	1/32	5292	3/8	11/64	1/8	5/64	13/64
5/32	5283	5/16	.169	1/8	1/32	5293	3/8	3/16	1/8	1/16	13/64
3/16	5284	3/8	.196	5/32	5/64	5294	7/16	7/32	1/8	3/32	15/64
1/4	5285	7/16	.257	3/16	7/64	5295	1/2	9/32	5/32	3/32	17/64
5/16	5286	1/2	.323	3/16	1/16	5296	9/16	11/32	3/16	3/32	21/64
3/8	5287	5/8	.386	1/4	3/32	5297	11/16	13/32	1/4	1/8	27/64

- ▶ Precision machined sets
- ▶ Available in case hardened steel or stainless steel
- ▶ Male washer O.D. is slightly smaller than female washer O.D.
- ▶ Please specify when ordering if you are requesting a set (male & female)

## Stainless Steel Swing "C" Washers



- ▶ Available with a flat surface or equalizing hole
- ▶ Made from 300 series stainless steel

Flat PART #	Equalizing PART #	A	B	C	D	E	Radius	F	G	Screw H	J
7750	7754	1-1/8	$\begin{matrix} +.0005 \\ -.0000 \end{matrix}$ .1875	13/64	9/16	3/16	3/8	.1870	PART#	5/64	
7751	7755	1-1/4	.1875	17/64	5/8	3/16	7/16	.1870	9256	3/32	
7752	7756	1-1/2	.250	21/64	3/4	1/4	1/2	.2495	PART#	1/8	
7753	7757	1-3/4	.250	25/64	7/8	1/4	5/8	.2495	9268	1/8	

